

FREQUENCY: Daily

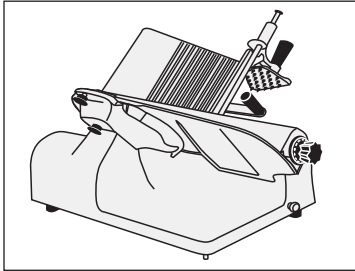

Supplies Needed:



Wash hands before and after each cleaning task

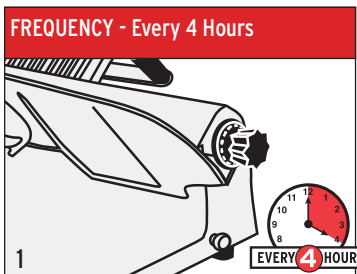

- Set blade to zero.
- Turn slicer OFF and unplug.
- Put on a pair of sanitized stainless steel mesh gloves and a pair of vinyl gloves over the stainless steel mesh gloves.

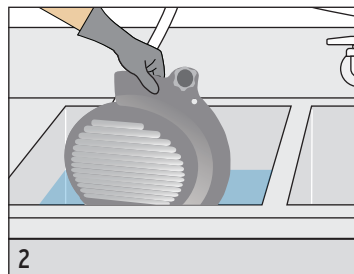

- Disassemble slicer.
 - Wash, rinse and sanitize removable parts in compartment sink with Sink Detergent and Sanitizer Solution.
 - Allow to air dry.
- NOTE:** If applicable, remove sharpening stone and wash in compartment sink.

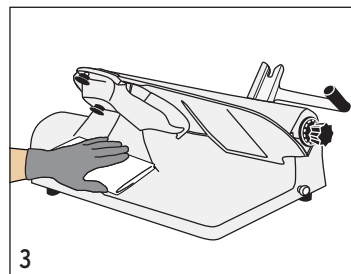

- Use paper towel to remove heavy debris and crumbs.

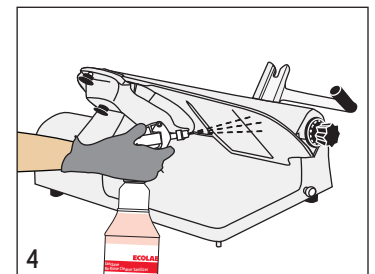

- Spray slicer base with fresh SaniSave Solution.

WARNING:
• Do not let solution enter clutch housing or carriage.

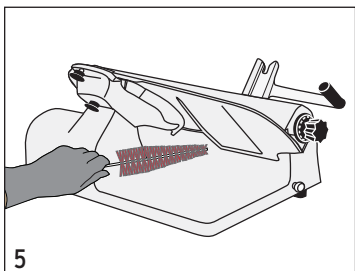

- Starting at the top of the slicer and working your way down, scrub all stationary slicer parts (including the feet and foot horseshoes) using paper towels, slicer brush, and nonabrasive pad.

WARNING:
• Use caution when cleaning blade.
• Clean from center of blade to outer edge only.

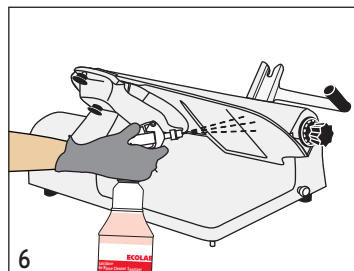

- After slicer has been cleaned, spray with fresh SaniSave Solution for a second time.
- Allow one minute contact time.
- Air dry or wipe with a new paper towel.

WARNING:
• Do not let solution enter clutch housing or carriage.

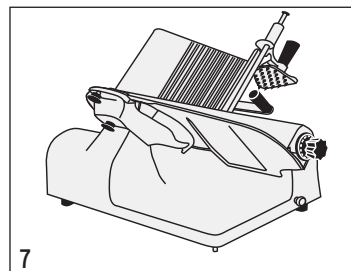

- Reassemble.
- Only reconnect electricity when complete.